



# HearLinkSet

## Wireless Remote Voice/Audio Transmitter and Receiver Set

### P/N NSRXRM3C2HRS

## USER GUIDE



**Declaration of Conformity.** We declare that product NSRXRM3C2HRS conforms to the R&TTE Directive 1999/5/EC.



FCC ID:TNZNSRXRM3C2XXX

CE 0678

## Introduction

Nolan Wireless HearLinkSet with remote voice/audio transmitter (Remhearlinks) and receiver (Hearlinks) together. It is a completed total solution to improve hearing impairments to understand more speech over a distance.

## Getting Started

Remove all components from the package. Items in the pack included:



HearLinks



RemHearlinks



Power adapter



Lanyard X2



USB charging cable X2



earphone



QSG



External  
microphone



Analog stereo  
audio cable



3.5mm  
stereo cable

Please check the contents carefully and contact your local dealer immediately if anything is missing or damaged.

## Getting to Know Your HearLinks and RemHearLinks

See image below. Please note some models will differ slightly in style, colour and the functionality may vary according to their specifications.

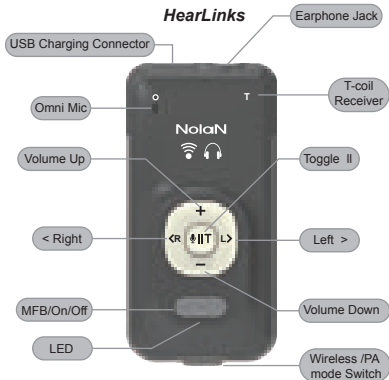

## RemHearLinks

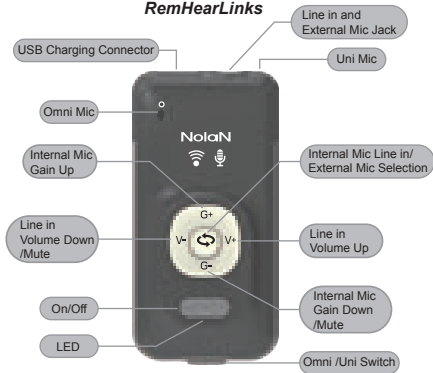

### Charging Your HearLinks and RemHearLinks

Plug the USB charging cable into the mini USB connector. Plug the other side of the USB charging cable into a powered USB connector.

When charging, the **amber LED** will be lighted. When charging is completed, the **amber LED** will be turn off.

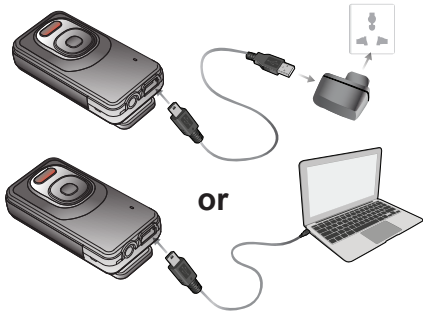

## **Wear Your HearLinks or RemHearLinks**

Wear with lanyard to loop around on neck or clip on collar for conveniently using.

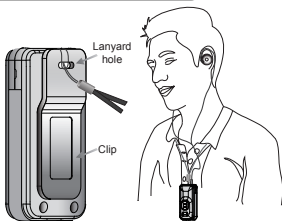

## Start using HearLinks and RemHearLinks Set

### Turn on and pairing HearLinks and RemHearLinks

You need to pair both HearLinks and RemHearLinks when both first time to use together.

1. On HearLinks, slide the Wireless/PA switch to select the Wireless mode.



 Wireless mode

2. Press and hold the MFB button for 2 seconds until **blue** and **amber** LED fast flashing alternatively.

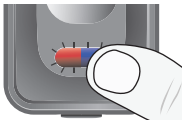

3. On RemHearLinks, Press and hold the ON/OFF button for about 2 seconds until **blue** LED blinking fast.

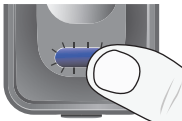

4. Both HearLinks and RemHearLinks will pair and connect each other automatically. The **blue** LED of both devices will change to flash slowly (approx once every two seconds) after completed pairing and connecting.

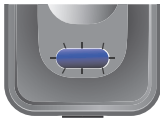

After paired, HearLinks and RemHearLinks will connect to each other automatically on later using. The blue light will change slow flash after connected.

### **Turn off HearLinks and RemHearLinks**

Press and hold the ON/OFF button of each device for about 2 seconds, the amber light will stay on for about 1 second before turn off. Release the ON/OFF button.

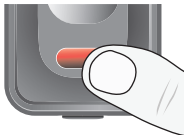

## Using for remote voice and commuicaiton

1. For remote voice links with embedded microphone transmit capturing and delivering the remote source of voice to listener wirelessly

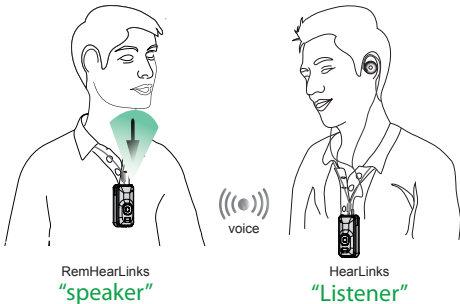

## Using for remote audio/music streaming

1. Connect to audio output of your TV, MP3 or music player to listen and enjoy TV or music wirelessly.



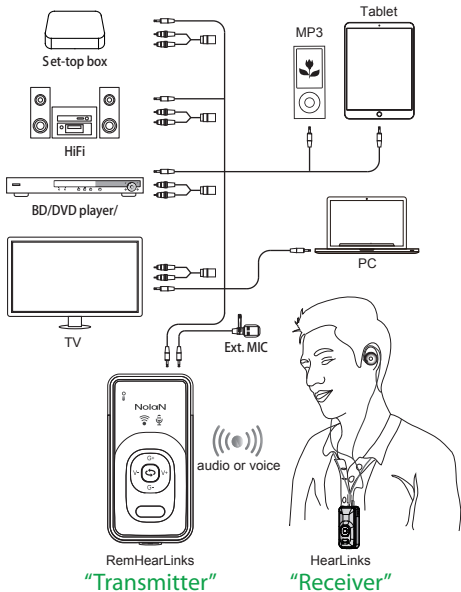

### ● Operation on RemHearLinks Unit:

The RemHearLinks supports internal and external microphone to capture the sound. When using microphone, put RemHearLinks to close the sound source within 8 inch to capture the best sound quality,

### How to use internal Uni and Omni directional microphone

● Both unidirectional and omnidirectional microphones have their advantages and disadvantages. The important thing is to know the application of the microphone in use to know which would be better for the given situation around.

Slide the microphone selection switch to choose the corresponding internal microphone.





 Omnidirectional

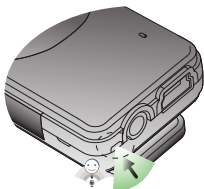

 Unidirectional

-  Unidirectional (Cardioid) microphone is used that the target sound source pick up directly in front of the microphone, and all other sounds from sides are largely rejected.



-  Omnidirectional microphones will pick up sound from all directions or sides around the microphone. Users can speak into any side of the microphone.



## How to use external audio source input: external microphone or external audio devices

Short press the input selection button, RemHear-Links will toggle the audio input source between internal microphone and external microphone/audio device.

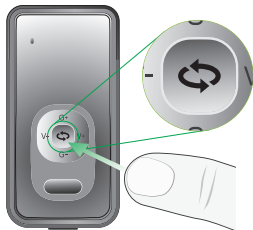

When you using internal microphone, the **blue LED** will flash up.

When you using external microphone/audio device, the **green LED** will flash up instead of **blue LED**.

## **RemHearLinks external microphone**

Plug the external microphone into the RemHearLinks audio jack, and then select the external microphone/audio device.

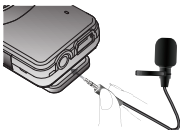

## **TV or other audio devices audio input**

Connect the TV or other audio devices 3.5mm to RemHearLinks via audio cable, and then select the external microphone/audio device.

Using 3.5mm audio cable or RCA audio cable converter to connect AUX or RCA audio output for TV sound output.

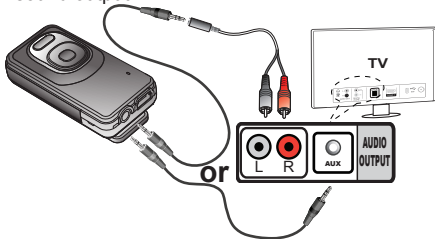

## Adjust microphone gain, input audio volume or mute

The four volume buttons, Mic Gain Up/Down and external audio Volume Up/Down, provide the flexible volume tuning functions.

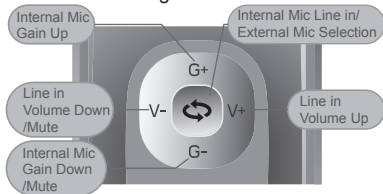

- G+ and G- : Single press to increase and decrease the internal microphone gain.
- G-: Press and hold about a second to mute the internal microphone, the **amber LED** will flash slowly. Then press G+ to un-mute
- V+ and V- : Single press to increase and decrease the external microphone or audio sound volume.
- V-: Press and hold about a second to mute the microphone, the **amber LED** will flash slowly. Then press V+ un-mute.

### ● Operation on HearLinks Unit:

Plug the earphone into the HearLinks audio jack, the audio or voice will be steamed to HearLinks and listen from earphone. HearLinks provides the customized hearing preferences settings. You can adjust the audio balance of left/right channel or select audio/sound enhancement profile to meet your personal preference needs.



### Adjust earphone volume

HearLinks earphone volume can be adjusted to your desired hearing needs.



The two buttons, “+” and “-”, allow you to adjust the earphone volume. User will hear a tone when reach max/min volume.

To mute the earphone, long press “-” and short press “+” to un-mute.

## Hearing preferences settings

### ◆ Enter the hearing preferences settings mode:

Press and hold the MFB and L> (or <R) button simultaneously for 1 second till blue and green LED light up at the same time.

### Hearing preferences settings

HearLinks provides the customized hearing preferences settings. You can adjust the audio balance of left/right channel or select audio/sound enhancement profile to meet your personal preference needs.

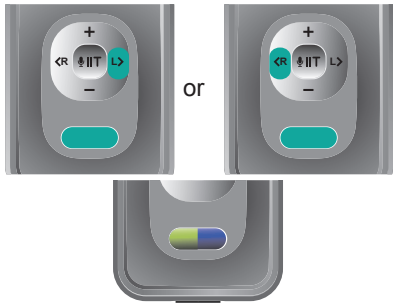



## ◆ Balance for L/R audio channel:

Balance between the left and right ear to compensate for a more volume in one ear

- Short press L>:  
Left channel enhance for 1 step, total 5 steps, user will hear a tone when reach max.



- Short press <R:  
Right channel enhance for 1 step, total 5 steps, user will hear a tone when reach max.



- Short press "IIT":  
Restore left and right channel to default equal balance.



## ◆ Hearing preference profiles setting:

There are 5 different hearing preference profiles

- 1- Pass through by default
- 2- Low frequency noise reduction
- 3- Speech high frequency enhancement
- 4- Middle and high frequency enhancement
- 5- Wider middle and high frequency enhancement
- 6- More middle and high frequency enhancement

- Short press + :  
Next preferences  
profile.



- Short press - :  
Previous preference  
profile.



The sequence of profile is circulated. Users will hear a tone when profile circulated back to 1st/default profile.

## ◆ Exit the hearing preferences settings mode:

After set to desired balance and hearing profile, you can single press the MFB button to exit. The blue and green LED will be turn off and remain to the normally LED indication.

All the currently volume, balance and hearing profile settings will be memorized by the HearLinks after power off. All of the settings will be kept when you turn on HearLinks next time.



✂ Hint: The earphone is a binaural design. You can cut one of earbud to become a monaural as needs for conveniently using

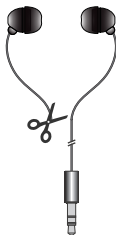

## Using HearLinks with Bluetooth mobile phone

### ◆ Pairing HearLinks with your Bluetooth mobile phone

Select the wireless mode, then press and hold the MFB button for 2 seconds. HearLinks will be turn on and enter pairing mode with **blue** and **amber** LED fast flashing alternatively.

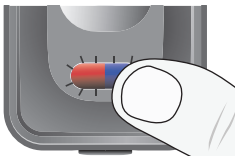

On other Bluetooth device, search and find the device named “HearLinks”, and then select “HearLinks” to pair. In some Bluetooth devices, it will find the HearLinks and pair/connect with it automatically.

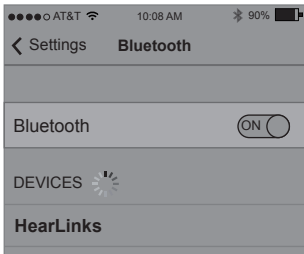

If pin code requested during pairing, please submit “0000”

When pairing is completed and connecting, the **blue LED** will begin to flash slowly.

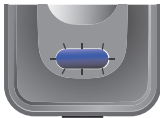

◆ **On HearLinks answer or end a call:**

When paired and connected with Bluetooth mobile phone, short press MFB button to answer incoming call or end ongoing call. To reject incoming call or redial last number, press and hold the MFB button for 1 second.

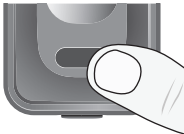

Put HearLinks' microphone close to the sound source around 8 inches to capture the best sound quality.

max. 20cm  
8 inches

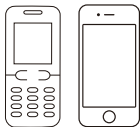

Your voice



Caller's voice



## Using multi link with Bluetooth mobile phone and RemHearLinks together at same time

HearLinks supports multiple links to connect both Bluetooth mobile phone and RemHearLinks at same time. Users can receive sound/audio from RemHearLinks and answer incoming call from HearLinks directly.

To pair and connect RemHearLinks and Bluetooth mobile phone at same time by using multiple links function of HearLinks, please follow these steps:

1. Pair with your Bluetooth mobile phone first. Turn on HearLinks to pair and connect with Bluetooth mobile phone.
2. After paired and connected. Then, turn off both Bluetooth function of mobile phone and HearLinks to prepare for RemHearLinks pairing.
3. Turn on, pair and connect both HearLinks and RemHearLinks.

4. After HearLinks and RemHearLinks are paired and connected, then you can turn on the Bluetooth function of mobile phone. In the Device list, select the name “HearLinks” to connect the HearLinks.

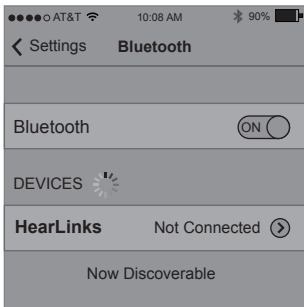

5. HearLinks completed multiple links and connected with RemHearLinks and Bluetooth mobile together at same time.



## Using HearLinks for personal sound amplifier/T-coil

When select the personal sound amplifier/T-coil mode, the **green** LED will flash slowly, the HearLinks will discard voice from RemHearLinks. The internal microphone or T-coil will provide sound to the earphone.



 PA mode



T-coil  
sound source  
transmitter device

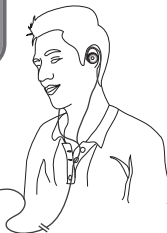

Short press Mic/T-coil button, the sound source of HearLinks will be toggled between internal microphone and T-coil.



## VISUAL INDICATION

The POWER/MODE/AUDIO LED can also indicate the status working statues.

### RemHearLinks working statues

Statues	Indication
Charging	Amber LED is On
Not Connected	Blue/Green LED very slow flashes, approx. every 5 seconds
Connected	Blue/Green LED slow flashes approx. every 2 seconds
Pairing mode with Bluetooth receiver	Blue/Green LED fast flashes
External audio source selected	Green LED flashing
Power On	Blue LED flash once
Power Off	Amber LED flash once
Mute	Amber LED slow flash, approx. every 5 seconds

## HearLinks working statues

Statues	Indication
Charging	Amber LED is On
Not Connected	Blue LED very slow flashing, approx. every 5 seconds
Wireless mode: Connected	Blue LED slow flashing, approx. every 2 seconds
Wireless mode: Pairing	Amber and Blue LEDs flash alternatively
Personal sound amplifier mode with microphone	Green LED slowly flashing.
Personal sound amplifier mode with T-Coil	Green LED fast flashing.
Hearing preferences setting mode	Green and Blue LEDs solid flashing.
Power On	Blue LED flash once
Power Off	Amber LED flash once

## TROUBLESHOOTING

Please note that you should also be familiar with the operation of your mobile phone or others about connecting Bluetooth device. Please read the User Guide for your device carefully.

### RemHearLinks troubleshooting

Problem	Likely Cause / Solution
RemHearLinks does not reconnect. Lost Connection. Blue LED flashes at 5 second intervals.	Distance between RemHearLinks and audio receiver' out of range. Put them closer and turn on to reconnect again.
RemHearLinks will not pair with HearLinks	Ensure both are at pairing mode, no other bluetooth devices are active around.

## HearLinks troubleshooting

Problem	Likely Cause / Solution
HearLinks does not reconnect. Lost Connection. Blue LED flashes at 5 second intervals.	Distance between HearLinks and wireless devices out of range. Put them closer and turn on to reconnect again.
Can not power on.	Connect power source to charge the battery.
Can not hear audio from Bluetooth devices.	Ensure the HearLinks is in corresponding wireless mode.
Cannot hear microphone or T-coil voice.	Ensure the HearLinks is in personal sound amplifier/T-coil mode, and toggle the voice source to microphone or T-coil.

## **CUSTOMER SERVICE INFORMATION**

For other Nolan Bluetooth products or support, please view our website – [www.nolan-sys.com](http://www.nolan-sys.com) or email [info@nolan-sys.com](mailto:info@nolan-sys.com) or contact your local representative.

## **DISCLAIMER**

Whilst every effort has been made to ensure that the information in this manual is accurate and complete, no liability will be accepted for any errors and/or omissions made. The manufacturer reserves the right to make changes and improvements to the specifications and features of the hardware and firmware of the products described in this document without prior notice. Reproduction, transfer, distribution or storage of part or all of the contents in this document in any form is prohibited without prior permission of the manufacturer. All trademarks acknowledged.

## **ENVIRONMENT**

Do not throw this electrical device away with the normal household waste at the end of its life, but hand it in at an official collection point for recycling. By doing this you will help to preserve the environment.

